

Here & Now: LUAG Celebrates 100 Years with 100 Local Artists

From the engineering and artistry of the original Lenape people, through the upheavals of the steel and railroad industries, to the hi-tech manufacturing of today, makers and innovators of all kinds have found a home in the Lehigh Valley. Perhaps unsurprisingly, this maker mindset found its way into the DNA of Lehigh University, shaping both artists and engineers and setting the stage for Lehigh University Art Galleries (LUAG).

Tracing our roots to 1926, the year of the first known art exhibition on campus, LUAG has grown into a vibrant museum with robust programs and a collection of over 20,000 works of art.

In honor of this milestone, LUAG presents an open call to a juried exhibition of 100 local artists reflecting the wide range of artistic practices thriving in our community today. Artists (aged 18+ years) in a range of media are encouraged to submit work to this salon-style exhibition which will take place in the LUAG Main Gallery.*

The exhibition will coincide with an initiative to make significant purchases of works by local artists for the university's collection.

**Please see detailed submission guidelines in the application below.*

TIMELINE

- Submission open: November 1, 2024
- Submissions close: Jan 5, 2025 (midnight)
- Jurying beginning of January
- Acceptance announced: March 1, 2025
- Loan agreements prepared and signed prior to drop-off
 - Drop-off dates determined.
- Drop off for members of Lehigh campus community: 5/5-5-9
- General drop off: 8/4-8/8
- **Show runs: September 2, 2025 - May 22, 2026**
- Pick up of works: May 26-29, 2026

JURYING

Works will be juried by the director and curators of Lehigh University Art Galleries in consultation with the museum staff, along with a guest community juror.

WHO CAN APPLY?

Region. Artists with any level of experience **aged 18+ years** living and working within the Lehigh Valley and neighboring communities within a 35-mile radius of Bethlehem, PA.

Artists living/working primarily in Philadelphia are not eligible for the exhibition.

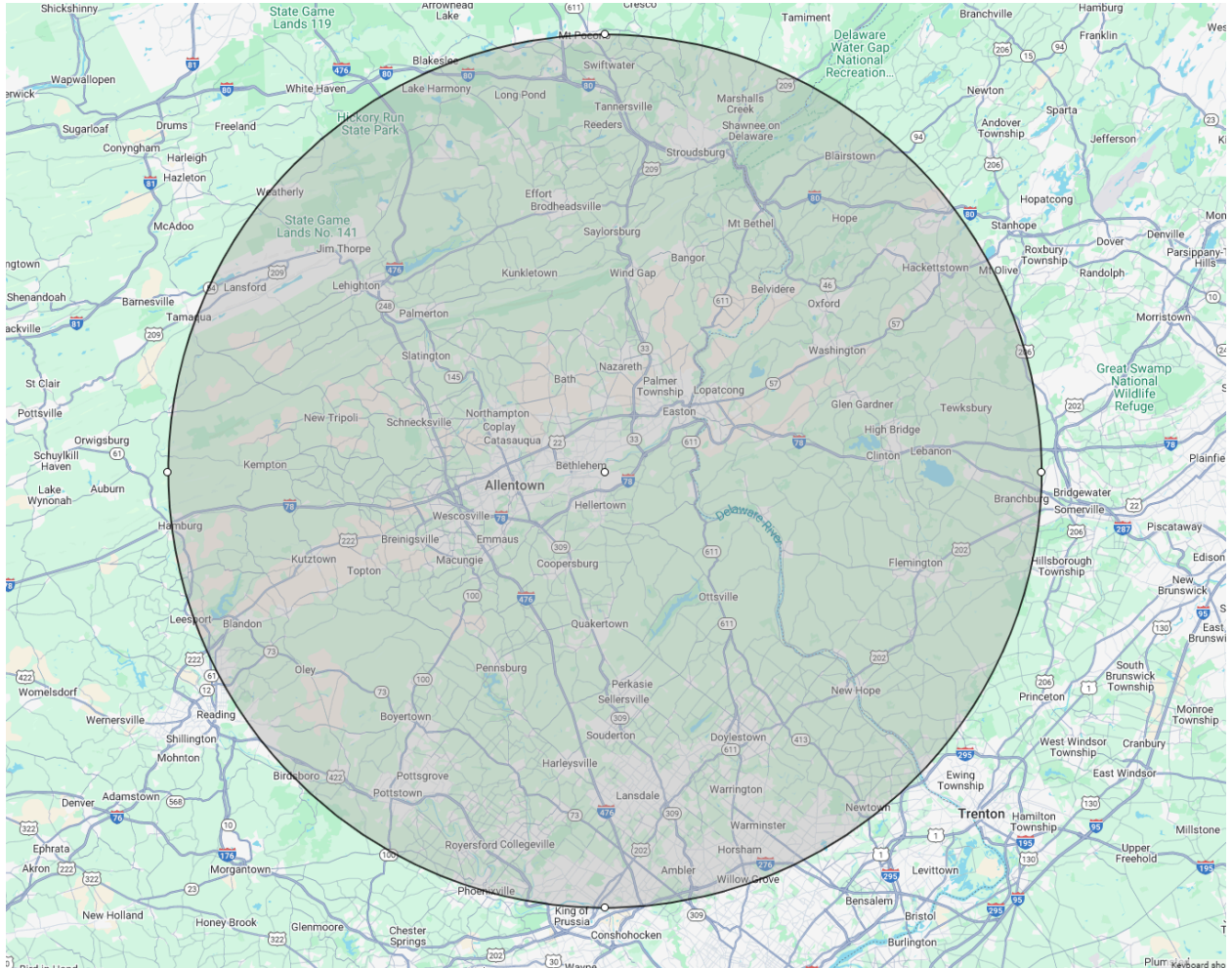

Media. LUAG encourages the submission of works in the following media.

- 2D and 3D works in all media.
 - Painting
 - Photography
 - Drawing
 - Printmaking
 - Textile
 - Sculpture
 - Metal
 - Glass

- Ceramic
- Mixed
- Other
- Installation works will be considered within the context of a 100-person salon-style group exhibition as space permits.
- Video works submitted as MP4 files, suitable to be shown on a 70" monitor, screened with other works.
 - Sound works may only be submitted as video (see above).
- Performance works may only be submitted as video (see above)
- No works that hang from the ceiling will be accepted.

Preparation of Works. Please pay close attention to the following guidelines. LUAG reserves the right to refuse works prepared in a way it finds insufficient.

- 2D works must arrive "ready to hang" with all appropriate hardware included and in place.
 - Frames should be of professional quality, wood or metal (not flimsy).
 - No prefab plastic frames
 - D-rings are preferred to wire. D-rings should be securely attached and ready to hang
 - If the work requires a different hanging strategy than the one described here, please contact us for clarification.
- 3D works must include a description of weight and clear instructions for installation/presentation. 3D works must stipulate whether a pedestal, platform, etc. is required, and specify preferred size.
- Video works submitted as MP4 files
- Sound work submitted as MP4 files
- Performance work submitted as MP4 files
- Please note whether power is required.
- If you are concerned or have questions about the appropriateness/preparation of your work for this exhibition, please contact us at inluag@lehigh.edu.

Submission of Works:

- **Submit up to three works**
- **Format.**
 - Submit works as high-quality .jpg files
 - 300 dpi at 8" x10" (3000 pixels on largest edge)
 - In addition to clear high-quality images of the work (above), please include shots of how the work is intended to be installed. This should include images of the work in its actual frame, attached to the wall, on a pedestal, other support. These images may be informal and are intended

to help us understand how the work meets the world. Please include any installation information we should be aware of.

- Video, sound, or performance works should be submitted as MP4 files at exhibition-level quality.
- **Size.** LUAG hopes to include the work of 100 artists in this salon-style exhibition. Please consider size in your submission.
 - We encourage artists who work at a large scale (6' x 6' or greater) to submit smaller works as well. However, large works will be considered.”
 - Please do not submit more than one large work.
 - Large: 6x6' or greater
 - Medium 3-6'
 - Small is under 3'
 - Please provide the framed / final size, as well as the image size
- **Insurance / Purchase Value**
 - Please include a value that LUAG may use for insurance purposes.
 - Indicate whether the work is available for purchase by LUAG, and at what price.
 - Please note: LUAG is not a commercial gallery. This information will not be part of the exhibition and will be used for internal purposes only. If a patron wishes to purchase a work in the exhibition, LUAG will connect them with the artist directly. All works, regardless of purchase, must remain on view at LUAG for the duration of the exhibition.
 - If the work is not for sale, please provide a value at which the work may be insured.

THE SPACE

The exhibition will take place in the LUAG Main Gallery, located in the Zoellner Arts Center on Lehigh University's Asa Packer campus (420 E. Packer Ave, Bethlehem, PA 18015). The gallery is roughly 2500 sf. Please consider the space parameters in light of a 100 person exhibition as you decide which works to submit. See map below:

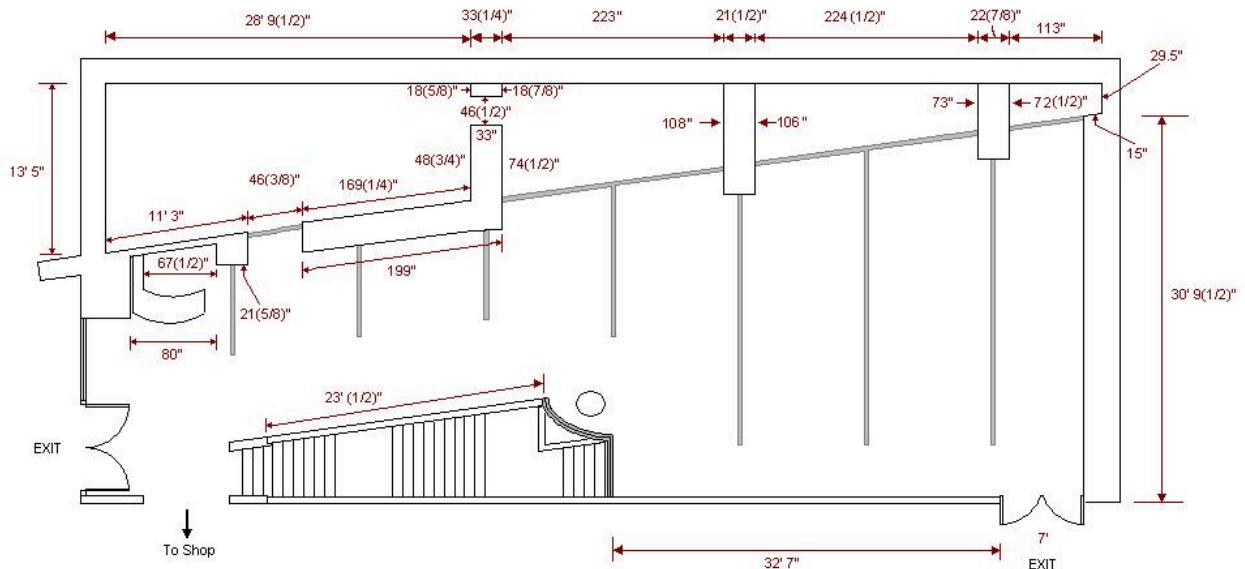

LUAG Main Gallery

SHIPPING

It is strongly recommended that artists drop off their works at the gallery in person.

If this is not possible, shipping arrangements must be coordinated with the gallery in advance. Shipping costs must be covered by the artist. Artwork must be received by August 8, 2025. A return shipment should be arranged for May 26-29, 2026, with a prepaid return shipping label included with the work.

LUAG is not responsible for the work(s) while in transit.

APPLICATION INFORMATION

First Name

Last Name

Address

City, State, Zip

Email

Phone

Pronouns

Brief artist statement or statement about the work (100 words or fewer)

Social Media handles

Bio (75 words)

CV or resume

Identify as Lehigh students, faculty, staff, alumnus, other student, faculty, staff, community member, educator/teacher, etc.

School/Grad year (if applicable)

Nationality

Personal identifiers (LGBTQ+, etc)

1. Would you like to self-identify as: (Select all that apply) (optional)
 - a. A person with a disability or other chronic condition
 - b. BIPOC
 - c. A member of the LGBTQIA+ community
 - d. I prefer not to disclose

ARTWORK INFORMATION

1. Artwork (category)

Title

Date

Medium

Dimensions

- Dimensions of artwork
- Dimensions of framed artwork

Weight (for sculpture)

Pedestal or base required? Dimensions preferred

Notes / Directions about hanging/installation:

Size category (small, medium, large)

Price or NFS [for LUAG use only]

Insurance Value

2. Artwork (category)

Title

Date

Medium

Dimensions

- Dimensions of artwork
- Dimensions of framed artwork

Weight (for sculpture)

Pedestal or base required? Dimensions preferred

Notes / Directions about hanging/installation:

Size category (small, medium, large)

Price or NFS [for LUAG use only]

Insurance Value

3. Artwork (category)

Title

Date

Medium

Dimensions

- Dimensions of artwork
- Dimensions of framed artwork

Weight (for sculpture)

Pedestal or base required? Dimensions preferred

Notes / Directions about hanging/installation:

Size category (small, medium, large)

Price or NFS [for LUAG use only]

Insurance Value

General Disclaimers

- Works submitted must be available for the duration of the exhibition period including installation and de-installation. 8/4/2025 - 5/29/2026. If an artist sells a work during the exhibition it cannot be removed from the exhibition. Artists are responsible for conveying works to buyers. LUAG will only release / return works to the artists.
- Artists will be required to complete a standard loan agreement/exhibition contract with LUAG prior to the delivery of works. LUAG will insure the works while on its premises. Claims of value will be evaluated by Lehigh University's insurers.
- LUAG reserves the right to refuse works of art for the exhibition which—upon arrival—vary significantly from how they were represented during the application process, or which pose unforeseen challenges, at the sole discretion of LUAG.
- LUAG reserves the right to publish submitted information and images about the artists and works in the exhibition for the purposes of promoting the exhibition.